

# INDOT LaPorte District 2020 Traffic Closure/Restriction Form

Revised August 6, 2020

Date: 3/29/2022 Submitter: Walsh-Herzog (Kevin Kegebein) Phone: 312-656-0853

Contract #: DT-01 Route: 12 County: Porter/LaPorte

Impact to Traffic:  CLOSURE  RESTRICTION  
Near City/Town/ Landmark: Michigan City, US 12/County Line Road

Restriction/Closure Details: 14 calendar day closure for new crossing and culvert work.

Maximum Vehicle Size and/or Weight Dimensions allowable through the Work Site safely: None.

Specific Location of Work Site: US 12 and NICTD rail crossing.

Length of Road Affected: 600'

Purpose of Closure/Restrict: 14 calendar day closure for new crossing and culvert work.  
(Project Type: R, RS, B, Culvert etc.)

Start Date/Time: 5/12/2022 7:00 A.M. End Date/Time: 5/26/2022 6:59 A.M.

Restriction Hours: None Contract Completion Date: 2/15/2024

Official Detour (Restriction as start/end points): See attached drawing. Dtr Length: 7.5 Miles

**Additional Information:** \_\_\_\_\_

**Instructions:** This information is to be emailed **ONE WEEK PRIOR** to the start of the work. Please give **THREE WEEKS PRIOR** for railroad work. This information is passed to the Department of Revenue to assist in reroute of OS/OW vehicles:

[aparkhouse@indot.in.gov](mailto:aparkhouse@indot.in.gov), [cbajek@indot.in.gov](mailto:cbajek@indot.in.gov), [astanley@indot.in.gov](mailto:astanley@indot.in.gov), [lahuffman@indot.in.gov](mailto:lahuffman@indot.in.gov) Tel: **(219) 325-7455**

All restrictions are to be reported **NO EXCEPTIONS**. It is the responsibility of the project engineer, supervisor, or INDOT Sub-district and/or Unit Foreman, to contact all local community services of the above work prior to the start of project. Please fill this section out prior to submittal.

**Community Service Notification** \_\_\_\_\_ (Duty of PE/PS/Foreman, etc.)

Fire	<u>Michigan City Fire Department, Pines Township Fire Department</u>	Date	<u>4-14-22</u>
Police	City <u>Michigan City Police Department</u>	Date	<u>4-14-22</u>
	County <u>La Porte County Sheriff (Michigan City) Dispatch</u>	Date	<u>4-14-22</u>
	State <u>IN State Police Crown Point</u>	Date	<u>4-14-22</u>
Ambulance	<u>Laporte County EMS</u>	Date	<u>4-14-22</u>
Schools	<u>Pine Elementary School, Michigan City Area Schools, Marquette Catholic HS</u>	Date	<u>4-14-22</u>
Postal Service	<u>Town of Pines, Michigan City Washington St. &amp; St. John Rd.</u>	Date	<u>4-18-22</u>
INDOT	<u>Lauren Huffman</u>		<u>4-18-22</u>

TO MILLENNIUM STATION

TO SOUTH BEND AIRPORT

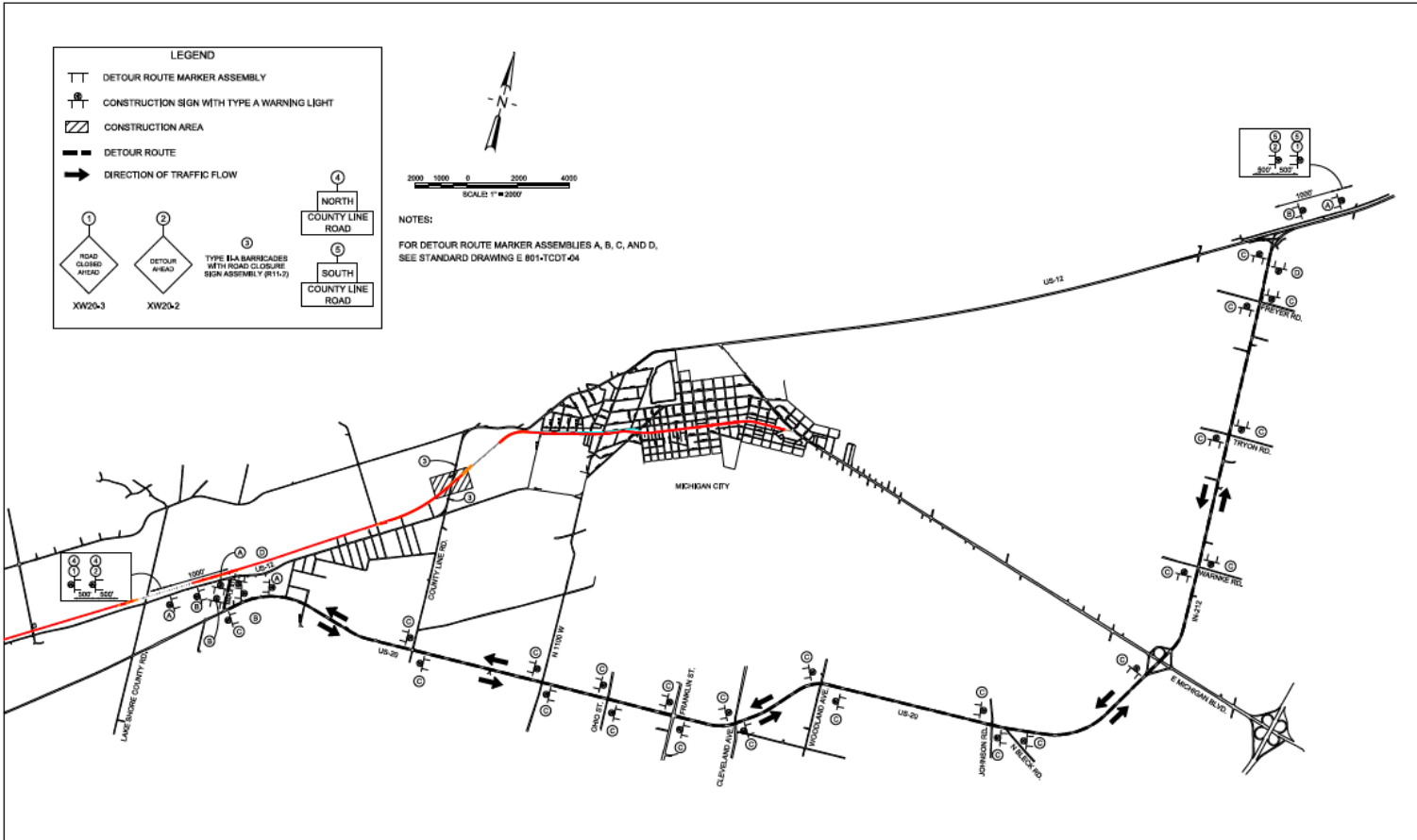

**LEGEND**

- TT DETOUR ROUTE MARKER ASSEMBLY
- Ⓜ CONSTRUCTION SIGN WITH TYPE A WARNING LIGHT
- ▨ CONSTRUCTION AREA
- DETOUR ROUTE
- ➔ DIRECTION OF TRAFFIC FLOW

XW20-3  
 XW20-2  
 TYPE B/A BARRICADES WITH ROAD CLOSURE SIGN ASSEMBLY (R11-7)

NORTH COUNTY LINE ROAD  
 SOUTH COUNTY LINE ROAD

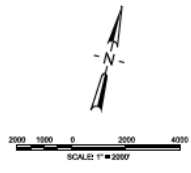

**NOTES:**  
 FOR DETOUR ROUTE MARKER ASSEMBLIES A, B, C, AND D, SEE STANDARD DRAWING E 801-TCDD-04

PLOT DATE: 6/30/2021 3:28:21 PM 62796

DRAWING MOT-324 OF MOT-325

 <small>301 S. Wacker Drive, Suite 1400 Chicago, IL 60601 TEL: 312.875.7700 www.aecom.com</small>	 <b>PATRICK</b> ENGINEERING		 <b>NICD</b> NORTHERN INDIANA COMMUTER TRANSPORTATION DISTRICT 33 East Highway 12 Chesterton, Indiana 46304	 <b>DOUBLE TRACK N.W.I.</b> Connectivity for Accelerated Growth MICHIGAN CITY TO GARY, INDIANA	DESIGNED: PEL/MWR DRAWN: PEL/MWR CHECKED: PFB/JJC DATE: 01/06/2021	NICTD - SOUTH SHORE LINE - MP 32.2 TO 38.8 DOUBLE TRACK MW
		<b>DETOUR PLAN</b> <b>COUNTY LINE RD.</b>			FILENAME: DT_DWS_MOT-SH4.ppt SCALE: AS NOTED	SHEET <b>210 OF 287</b>